

Replacement Models

H.P.	Volts	Amps	RPM	Spd.	Model	Fig.	Type	Mtg.	Dia.	Rot.	"A" Dim	Shaft Dia. and Length	Reference No.
WILLIAMSON													
80CFM	115	1.1	3000	1	A080	G	S.P.	—	—	C.W.	—	—	7021-5510, 02-568
118CFM	115	1.8	3000	1	A118	H	S.P.	—	—	C.W.	—	—	100,000 BTU Furnace 7021-6999, 7021-7042 Leads must be modified
YORK													
1/40	460	.37	3200	1	D1191	I	SP	Stud	3.3	C.C.W.	5-3/4	1/4 x 2-1/2	7121-7255
1/15	460	.6	3000	1	D1171•	A	SP	Stud	3.3	C.C.W.	6-3/4	1/4 x 2-1/2	024-24115-004 F33HXJB3621
1/5	208-230	1.2	1075	1	D1042	B	PSC	Band	5.0	D.S.	4-1/8	6-1/2 x 1/2 x 6-1/2	Cond. Fan, D1041 F47HXBGM-927
1/2	230	3.2	1050	1	D873•	C	PSC	Band	5.6	D.S.	4-1/2	9-3/4 x 1/2 x 9-3/4	K44HXJAF-4955
1-3/4-1/2	460	3.3-2.3 1.9	1100	3	D2871■†	F	PSC	Band	5.6	Rev.	6	1/2 x 3-1/2	024-21673, K55HXJFJ-2832 5KCP395GH913BS
65CFM	230	.60	3000	1	A063	D	SP	—	3.3	C.C.W.	—	—	26-22239
83CFM	230	.80	3000	1	A083•	E	SP	—	3.3	C.C.W.	—	—	026-16323-0000 026-20224-000, 7021-1373
—	208-230	.5	3000	1	A144^	J	SP	—	3.3	C.W.	—	—	7021-6770
—	115	.7	3450	1	A137	K	PSC	—	3.3	C.W.	—	—	7062-2442, 7062-3342, 7062-3484
—	115	.7	3450	1	A147	L	PSC	—	3.3	C.W.	—	—	7062-3342, 024-25007-700
—	115	1.2	3000	1	A154	M	SP	—	3.3	C.W.	—	—	7021-9428
—	115	.7	3450	1	A165	N	PSC	—	3.3	C.W.	—	—	7062-3958
—	115	.7	3450	1	A168	O	PSC	—	3.3	C.W.	—	—	7062-5019

NEW

• Ball bearing motor ■ 25M 370V Capacitor ^ Includes centrifugal switch
 † Has special OEM wiring configuration. Not for general purpose 3 speed applications.
 NOTE: Rotation is determined by looking at shaft end. Shaft length is measured from motor face.



Fig. A D1171



Fig. D A063



Fig. G A080



Fig. J A144



Fig. M A154



Fig. B D1042



Fig. E A083



Fig. H A118



Fig. K A137



Fig. N A165



Fig. C D873



Fig. F D2871



Fig. I D1191



Fig. L A147



Fig. O A168

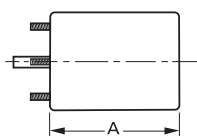

Products on this page are NOT SUITABLE for unattended equipment unless indicated by ► symbol. See inside back cover for additional information.

PSC motors use 5M 370V capacitors unless otherwise indicated.